

- NOTES:
1. ALL CONCRETE TO BE GDOT CLASS A (3,000 PSI)
 2. VALLEY GUTTER TO HAVE A COARSE BROOM FINISH
 3. ALL RADIUS DIMENSIONS ARE TO BOC
 4. ANY DAMAGED ASPHALT ALONG EDGE OF GUTTER TO BE SAW CUT, REMOVES AND REPLACES WITH CONCRETE.
 5. COST OF REPLACEMENT OF DAMAGED ASPHALT AND FLUME TO BE INCLUDED IN UNIT COST OF CURB AND GUTTER.
 6. EDGE OF GUTTER TO BE FLUSH WITH EXISTING ASPHALT
 7. ALL CONSTRUCTION STAKING WILL BE CONDUCTED UNDER THE SUPERVISION OF A GEORGIA REGISTERED PROFESSIONAL LAND SURVEYOR.



- ESTIMATED QUANTITIES:
- EROSION CONTROL: LS
 - DEMO ASPHALT: 104 SY
 - DEMO CURB AND GUTTER: 20 LF
 - G. A. B.: 30 TON
 - 24" CURB AND GUTTER (TYPE 2 CURB): 720 LF
 - VALLEY GUTTER: 98 SY
 - 36" HDPE PIPE: 40 LF
 - DI W/ PEDESTAL TOP AND COLLAR: 1 EA
 - 1033 SWCB: 1 EA
 - SOIL BACKFILL: 80 CY
 - REVEGETATE DISTURBED AREA: 0.25 AC
 - QUANTITIES TO BE FIELD VERIFIED BY CONTRACTOR.

OWNER AND DEVELOPER
 CITY OF DAHLONEGA
 465 RILEY ROAD
 DAHLONEGA, GA 30533
 PHONE: (706) 864-6133
 ATTN: MARK BUCHANAN
 mbuchanan@dahlonega.gov
 VINCE HUNTSINGER
 vhuntsinger@dahlonega.gov

24-HOUR CONTACT
 VINCE HUNTSINGER
 (706) 973-9933

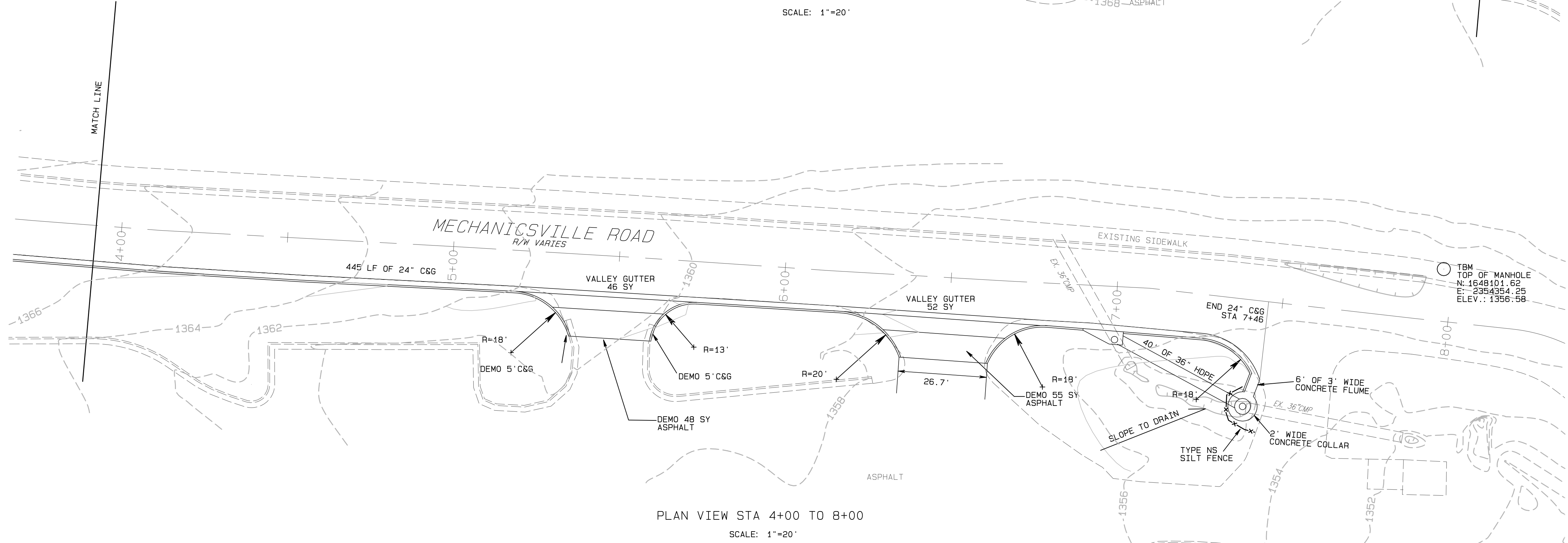
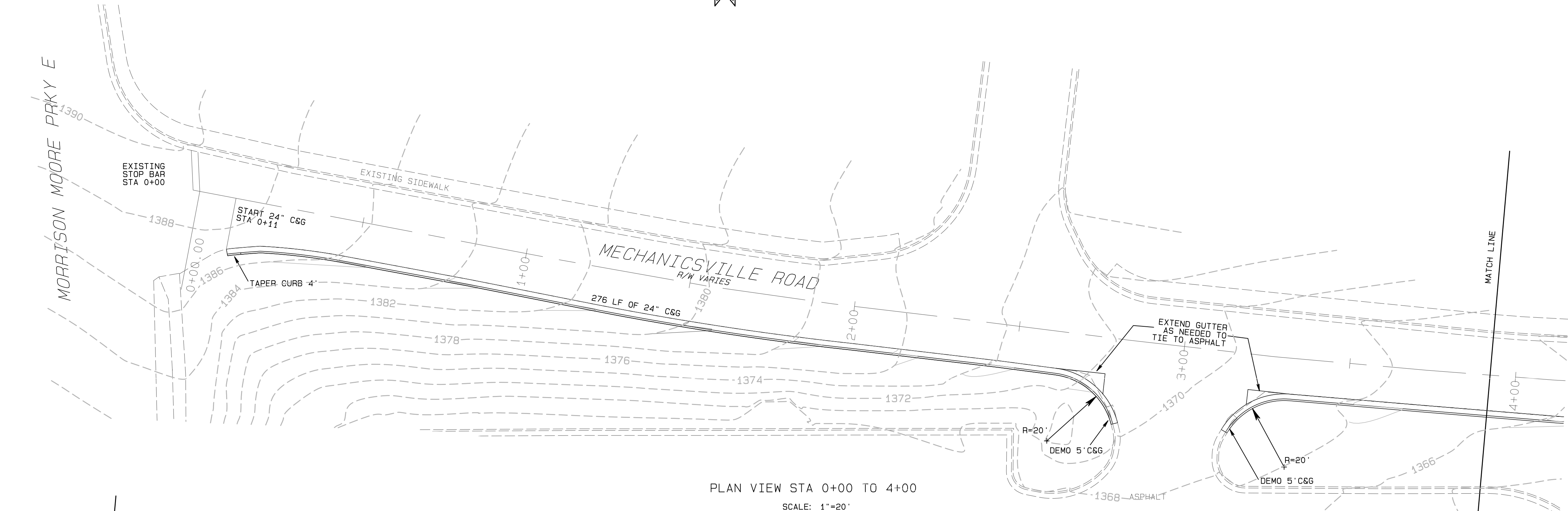
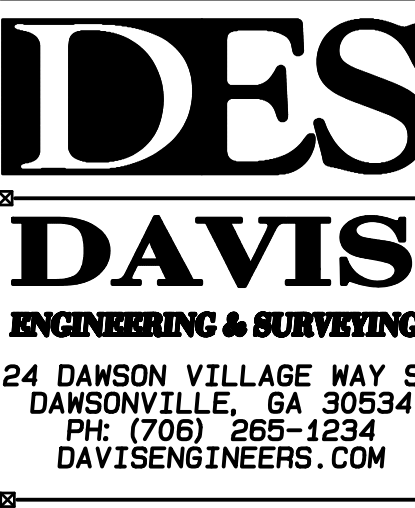

REVEGETATE SPECIFICATIONS

THE PER ACRE APPLICATION RATES:
 AGRICULTURAL LIME: 4000 LBS/AC.
 FERTILIZER, 5-10-15: 1500 LBS/AC.
 HAY OR STRAW MULCH: 5000 LBS/AC.
 FESCUE SEED: 50 LBS/AC.

PROCESS:
 GRADE, SHAPE AND SMOOTH WHERE NEEDED TO PROVIDE FOR SAFE EQUIPMENT OPERATION FOR MAINTENANCE PURPOSES. THE LIME AND FERTILIZER IN DRY FORM WILL BE SPREAD UNIFORMLY OVER THE AREA IMMEDIATELY BEFORE SEEDBED PREPARATION. A SEEDBED WILL BE PREPARED BY SCARIFYING TO A DEPTH OF 1 TO 4 INCHES AS DETERMINED ON SITE. THE SEEDBED MUST BE WELL PULVERIZED, SMOOTHED AND FIRMED. SEEDING WILL BE DONE HAND SEEDER. SEED WILL BE DISTRIBUTED UNIFORMLY OVER THE AREA. MULCH WILL BE SPREAD WITH BLOWER-TYPE MULCH EQUIPMENT OR BY HAND.

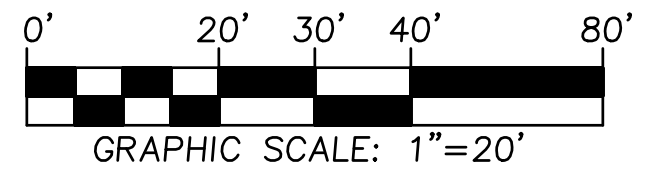

| REVISION | DATE | DESCRIPTION |
|----------|------|-------------|
| | | |
| | | |
| | | |
| | | |
| | | |
| | | |
| | | |
| | | |
| | | |
| | | |

CURB AND GUTTER PLAN
MECHANICSVILLE RD.
 CITY OF DAHLONEGA
 LUMPKIN COUNTY, GEORGIA

DRAWN BY: LR
 FIELD CREW: RS/AD
 DATE: 12-14-22
 CHECKED BY: JKD

SHEET NO.
 1 OF 2

PROJECT NO.
 2021-066

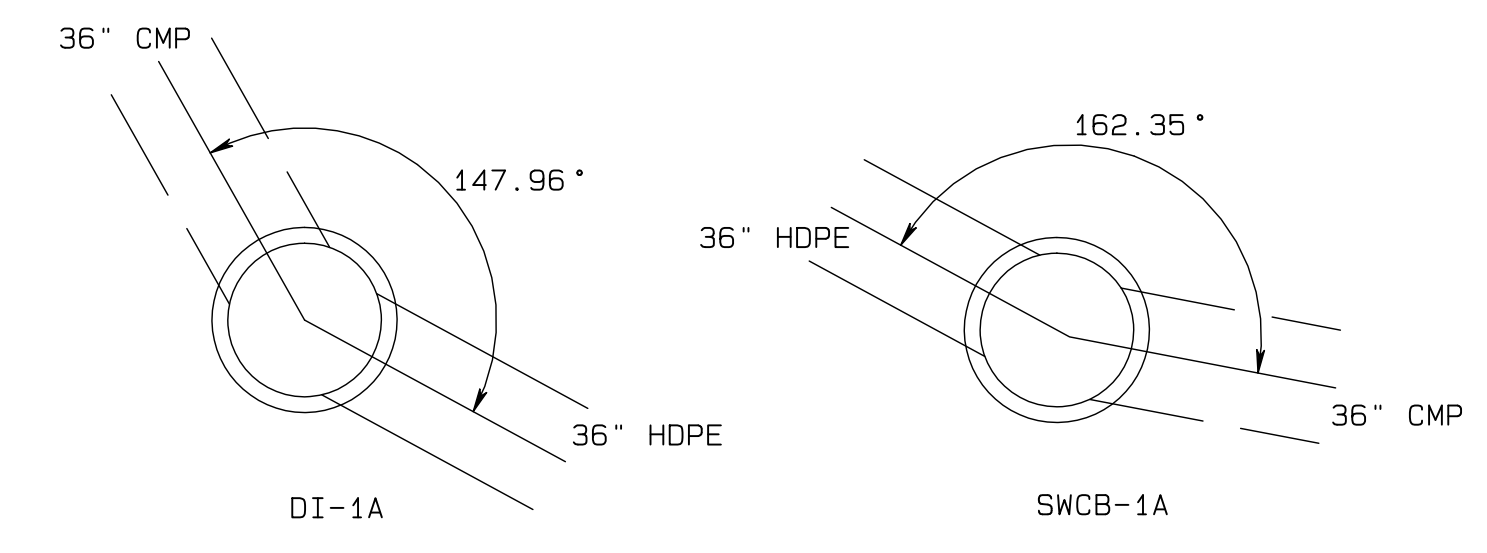
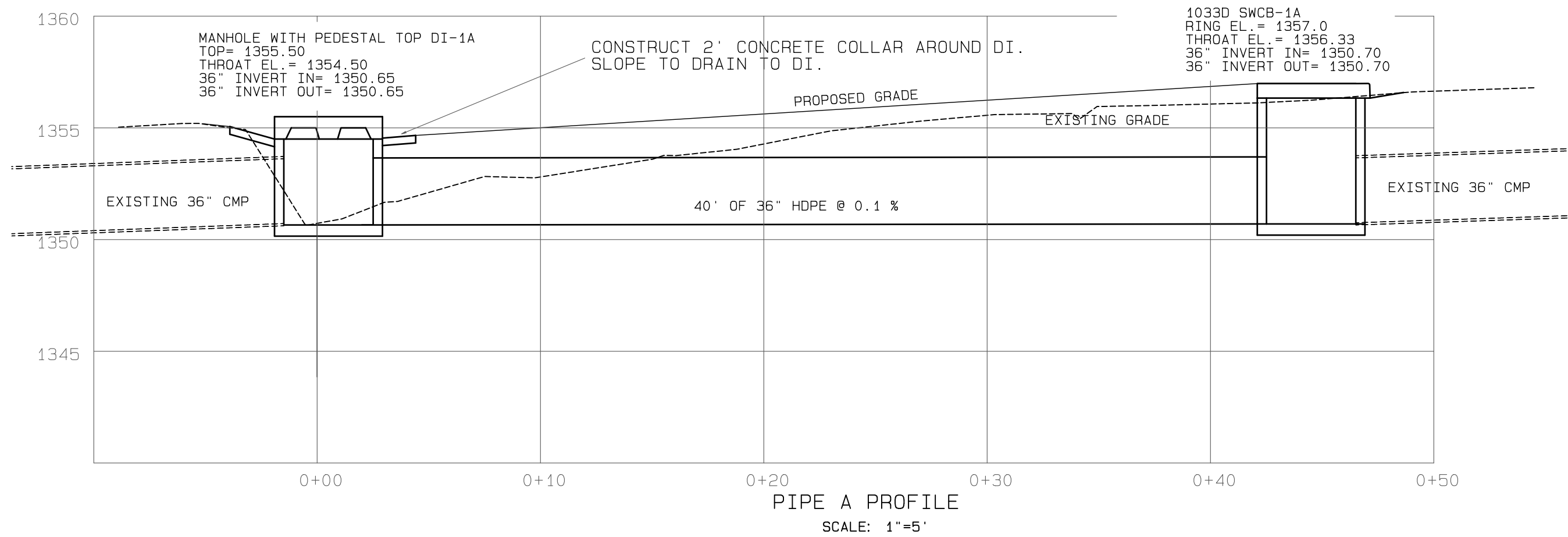

OWNER AND DEVELOPER
 CITY OF DAHLONEGA
 465 RILEY ROAD
 DAHLONEGA, GA 30533
 PHONE: (706) 864-6133
 ATTN: MARK BUCHANAN
 mbuchanan@dahlonega.gov
 VINCE HUNSINGER
 vhunsinger@dahlonega.gov

24-HOUR CONTACT
 VINCE HUNSINGER
 (706) 973-9933

DES
DAVIS
 ENGINEERING & SURVEYING
 24 DAWSON VILLAGE WAY S.
 DANSONVILLE, GA 30534
 PH: (706) 265-1234
 DAVISENGINEERS.COM

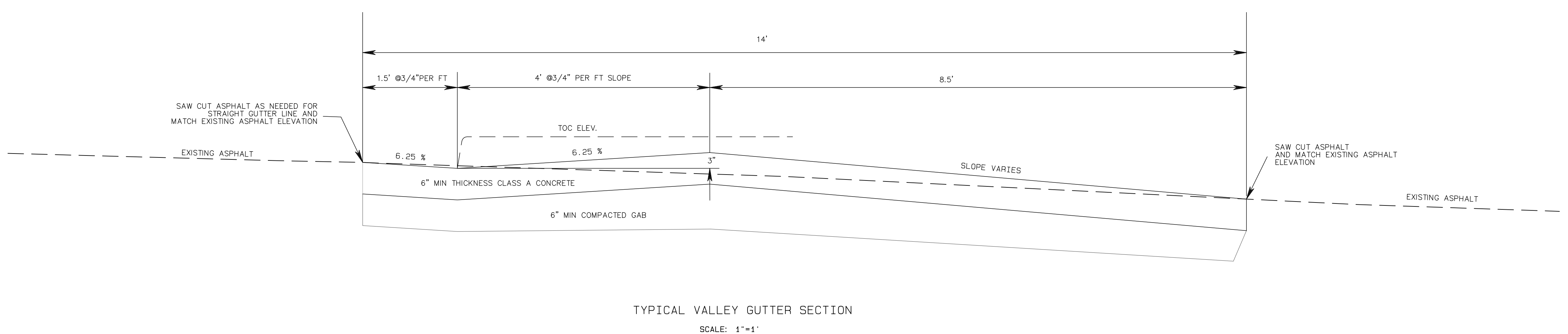
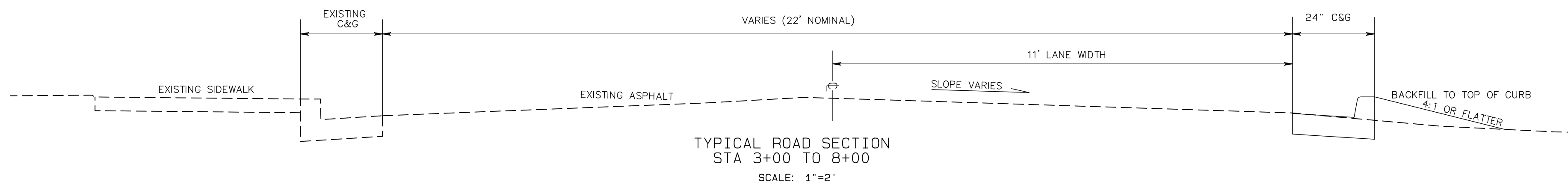
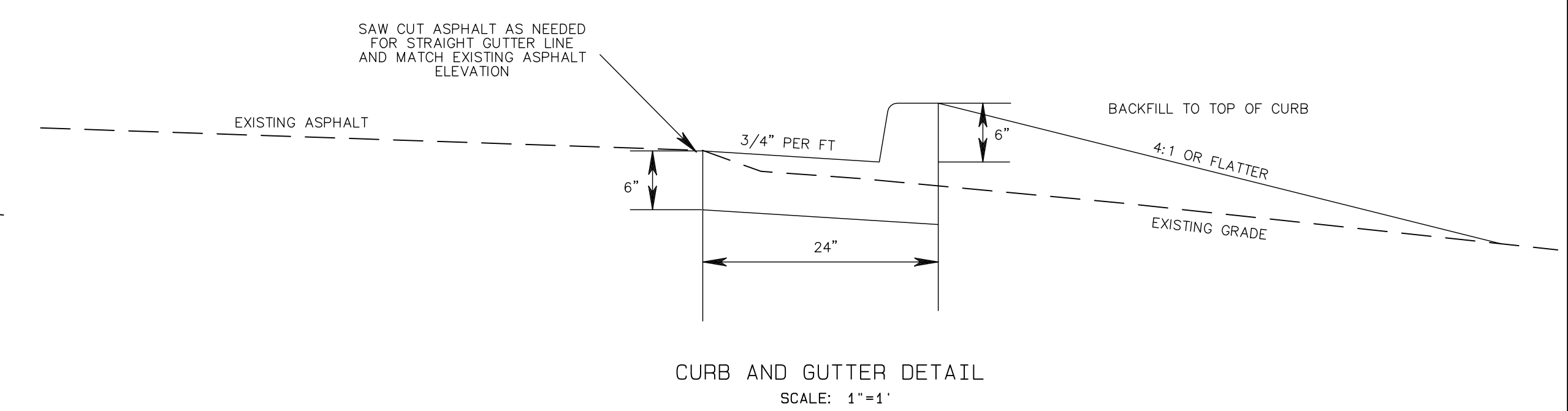
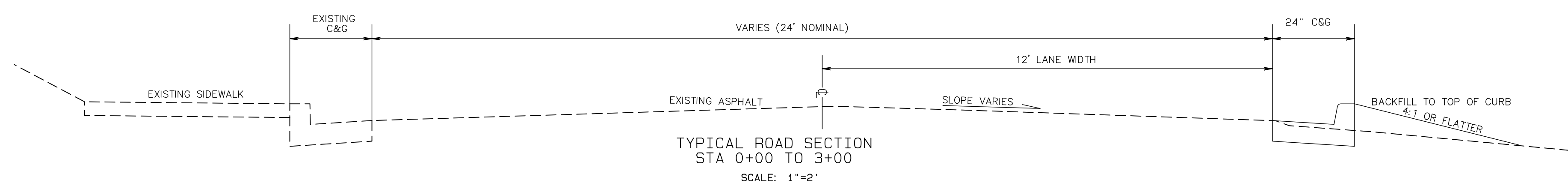

| REVISION | DATE | DESCRIPTION |
|----------|------|-------------|
| | | |
| | | |
| | | |
| | | |
| | | |
| | | |
| | | |
| | | |
| | | |
| | | |

CURB AND GUTTER DETAILS
MECHANICSVILLE RD.
 CITY OF DAHLONEGA
 LUMPKIN COUNTY, GEORGIA

DRAWN BY: LR
 FIELD CREW: RS/AD
 DATE: 12-14-22
 CHECKED BY: JKD

SHEET NO.
 2 OF 2
 PROJECT NO.
 2021-066